

MITSUBISHI ELECTRIC
CITY MULTI

Bell Canada Toronto.



Bell Canada in Toronto one of the City Multi installation sites in Canada.

Bell Canada in Toronto is one of the Canadian installation sites for City Multi.

Ducted indoor units supply the office areas, and LAN room with airconditioning, while adequate ventilation is ensured by the introduction of fresh air into the return air of all the ducted air handling units.

One set of refrigerant pipes connect all the indoor ducted units with the VRF (variably refrigerant flow) City Multi condensing unit situated on the building roof.

The variable refrigerant flow ensures year round cooling of the LAN room, even while the office areas are heated during the winter months.

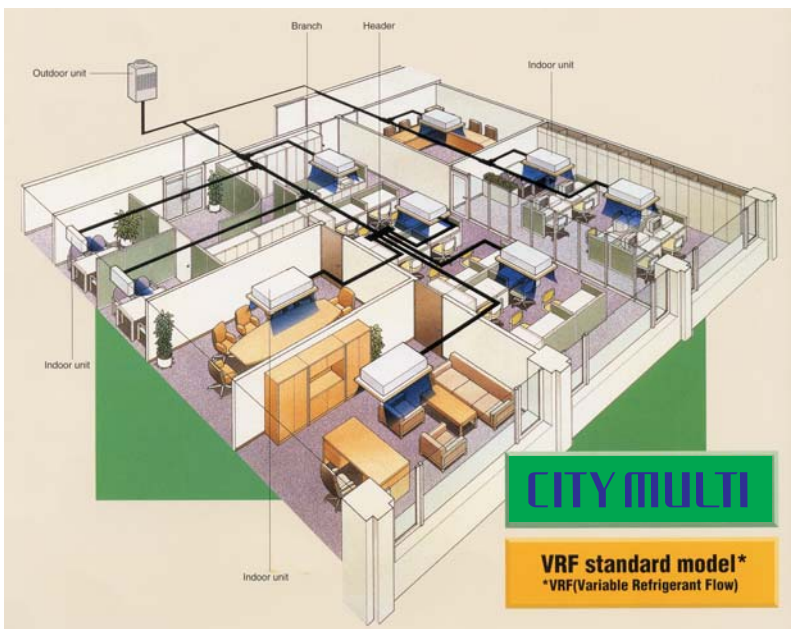

A typical City Multi Y-series installation, multiple indoor units can be connected to one VRF (variable refrigerant flow) outdoor unit. Power consumption is up to 30% less than conventional systems due to the new technology inverter control.

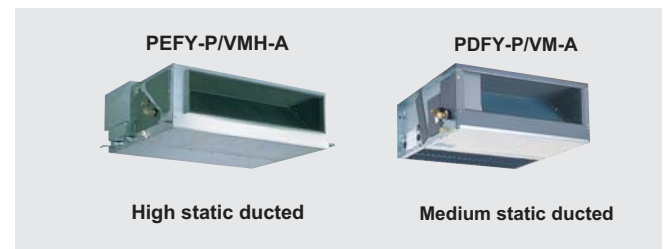

The air handling units used at Bell Canada.



City Multi Y-series VRF (variable refrigerant flow) condensing unit used at Bell Canada Toronto.